

USER MANUAL

Raised toilet seat with folding armrests

Product code: KING-12FA-20

Dear Customers,

Thank you for purchasing our product. We hope that the equipment you have selected will meet your expectations. We would like to share some important information with you.

Timago International Group is a Polish company which distributes medical, rehabilitation and orthopaedic products to pharmacies and medical stores.

Our mission is to ensure your comfort by offering safe, functional, and high-quality products.

We have many years of experience in this sector. Timago products reach a wide range of users in Poland and throughout Europe through our distributors (medical retailers).

Timago's company culture promotes openness to your needs. Our goal is to promote safe and correct use of our products for treatment and rehabilitation in order to improve comfort and quality of life.

We invite you to access our website for more information: **timago.com**.

1. Introduction

Prior to use of our products you should inspect the equipment for any defects which may have occurred during transport. If this happens, please contact your retailer.

Then, please read this instruction which includes important information for the user.

Please contact us if you have any questions concerning the use of the equipment. Our advisors will provide you with any information you require on an ongoing basis.

Please note that if you have questions other than those concerning the use of our products, you should contact your doctor, nurse or physical therapist.

2. Characteristics

Toilet seat is made of durable plastic material. It is equipped with modern mounting system with anti-sliding protection, swing away armrests and cut out at the front which facilitate performing hygienic activities in sitting position. Ergonomically designed surface of the toilet seat results in equal distribution of pressure force on the user's body. The slight downward incline of the toilet seat promotes correct posture and reduces flexing of the hip and knee joints. The surface is easy to clean and resists stains and smells. This raised toilet seat fits to majority of toilet bowls.



3. Application

Raised toilet seat is ancillary equipment which helps the user to perform hygienic activities.

The raised toilet seat is recommended to people with reduced mobility who have difficulties in sitting and standing up when using the toilet and for patients after hip operation.

4. Assembly and general recommendations for use

Note! Follow the information contained in this manual while assembly and adjustment. Users with reduced mobility may need help from a third person who has appropriate skills.

Note! Do not use the toilet seat when you notice any visible or perceptible damage (e.g. crack) as this may cause an accident.

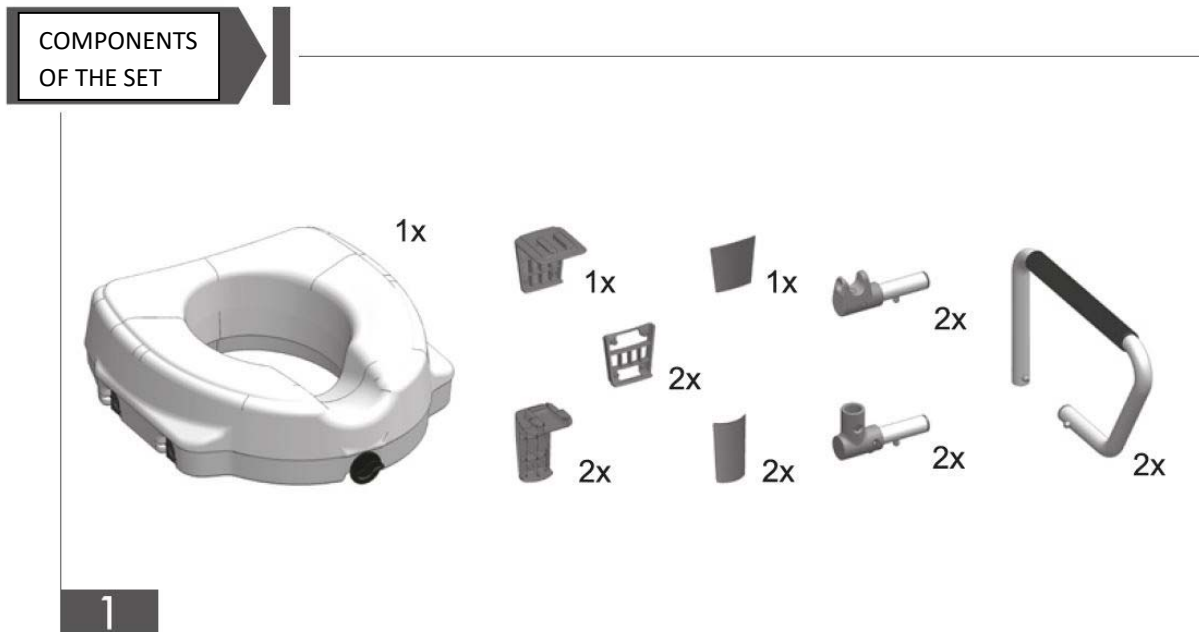
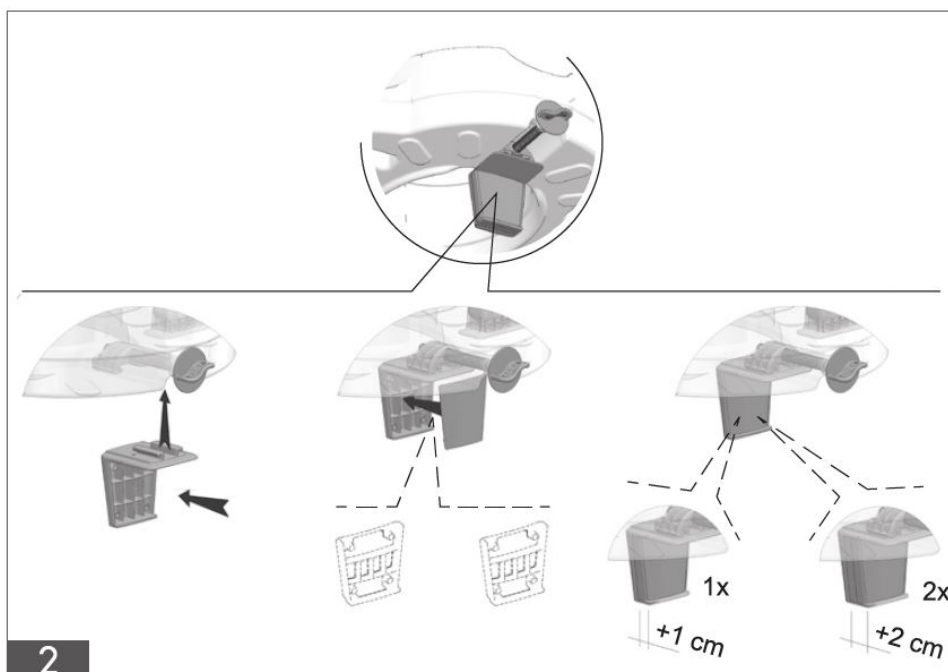
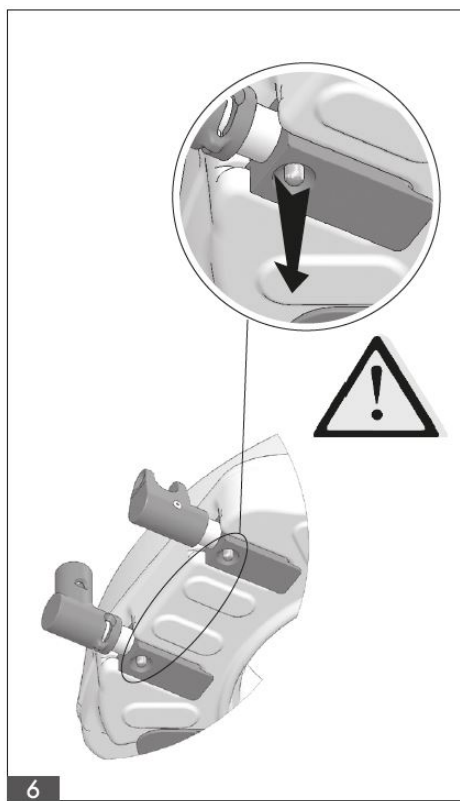
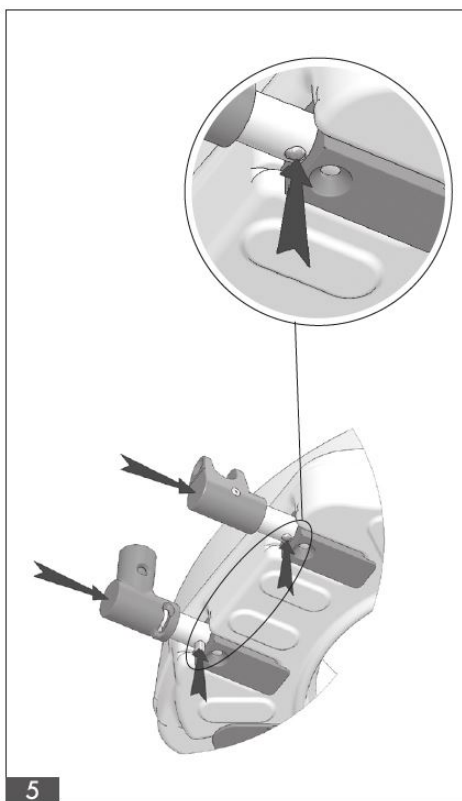
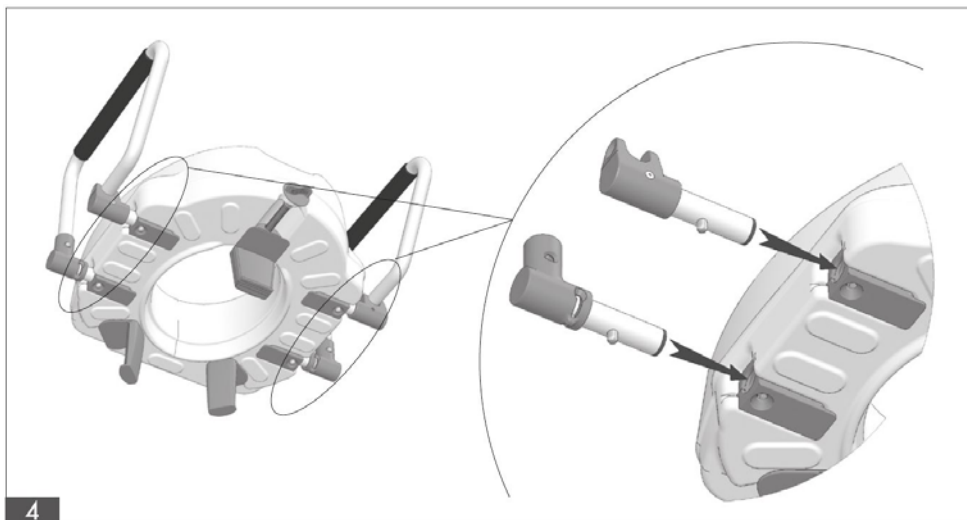
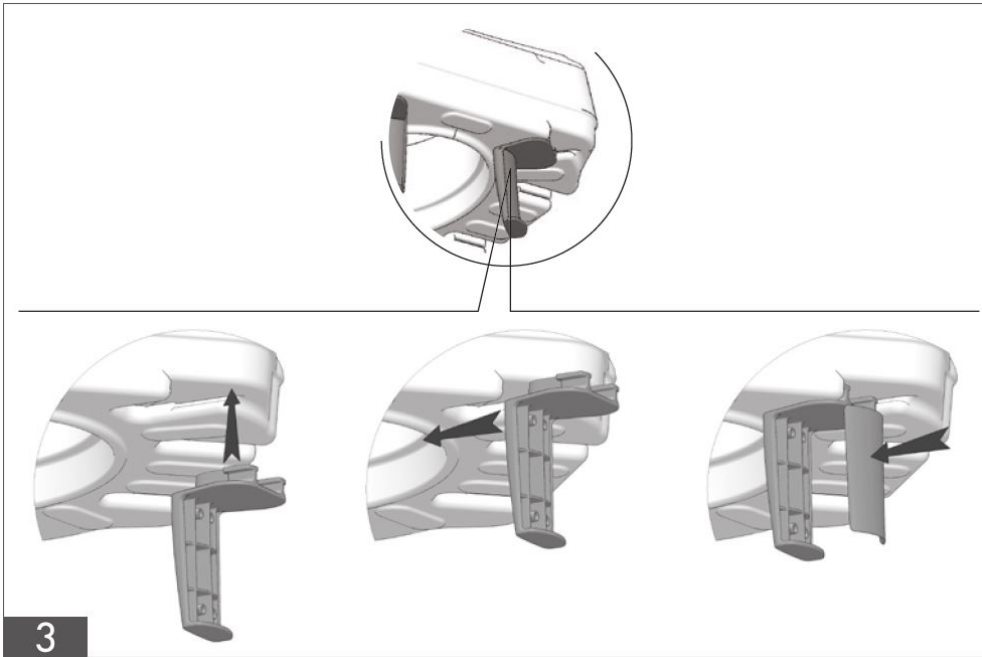
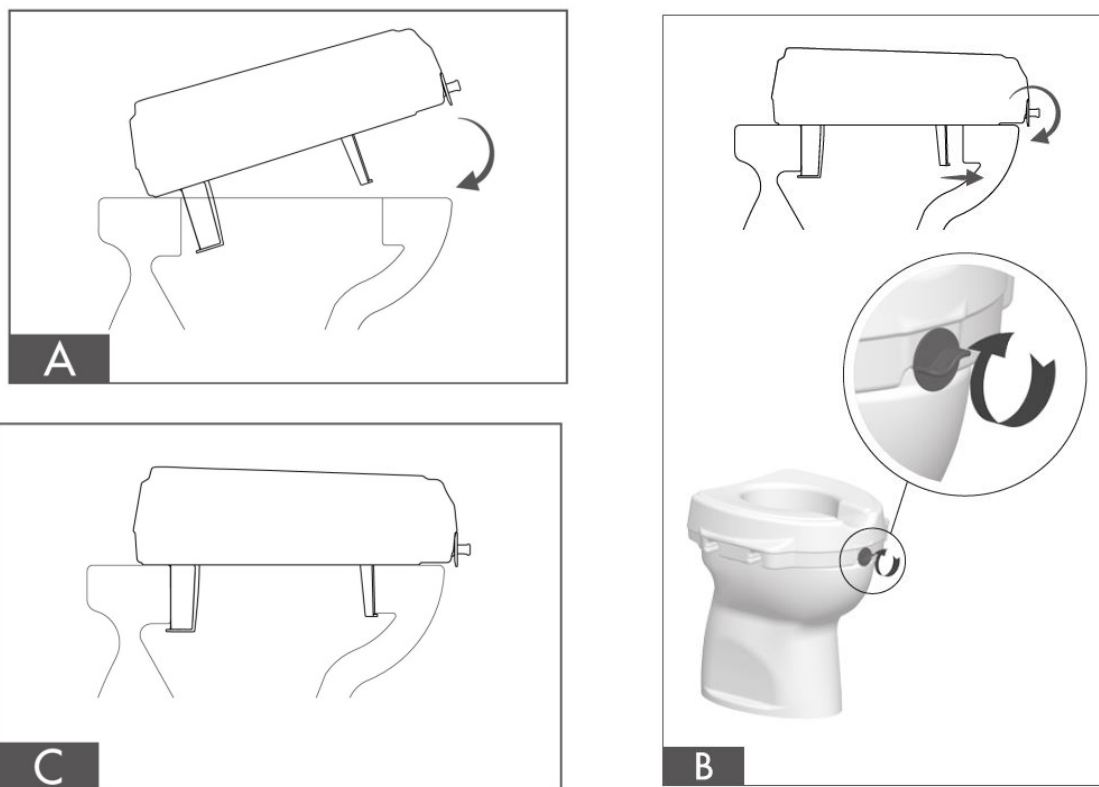

Fig. 2. Fix the bracket in the front part of the raised toilet seat, additional insets (1 cm or 2 cm) according to the size of toilet bowl, and then, protective cover.







Note! Adjust the bracket to the width of the toilet bowl with the use of adjustment knob (B). Before use, ensure that the raised toilet seat is correctly mounted and the bracket is correctly tightened.

5. Technical data

Inner seat dimensions	20 x 25 cm
Outer seat dimensions	39 x 43 cm
Height	12 cm
Weight	1.40 kg
Maximum capacity	130 kg

6. Notes and recommendations

- Patients with reduced mobility require help from a third person.
- **Do not** exceed maximum capacity of the raised toilet seat (130 kg).
- **Do not** stand on the raised toilet seat.

- **Do not** attach any objects to the raised toilet seat as it may cause an accident.
- Only one person can use the raised toilet seat during hygienic activities.
- Remove all potential obstacles in the bathroom and make sure that the floor is flat. Slippery floor should be secured with e.g. anti-slip mats.
- **Do not** make any repairs or modifications by yourself. Any repairs should be done by qualified personnel of the manufacturer.
- Do not store the raised toilet seat in rooms in the temperature below zero and in the open air.

NOTE! Timago International Group does not bear responsibility of improper use of the raised toilet seat, failure to comply safety regulations and misuse.

7. Maintenance

- Clean the raised toilet seat regularly using only water and mild detergents. Dry thoroughly.
- **Do not use** for cleaning: strong polishing agents and detergents, abrasive agents, bleach, petrol or solvents (it may cause product damage, visible defects and in consequence - loss of warranty rights).
- At least once every three months check:
 - condition of armrests
 - condition of adjustment knob
 - condition of locking pins

8. Warranty information









All products distributed by our company are under a warranty, the terms of which are described in the warranty card received at the time of purchase.

Please, keep in mind that for warranty purposes, the proof of purchase (receipt or invoice) should be retained.

As a user friendly company, we only supply products which have been thoroughly tested with respect to materials, quality and functionality.

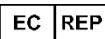
Please contact us if you have any questions concerning our servicing procedure.

9. Labels

	Reference number		Manufacturer
	LOT number		Manufacture date
	Serial number		Representative in European Union
	Note		Please read the instruction
	The Manufacturer checked for compliance with essential medical devices requirements.		

10. Recommended products

- Products offered by Timago International Group include:
- Orthoses and joint stabilizers
- Manual and special-use wheelchairs
- Walkers and rollators
- Crutches and canes
- Rehabilitation beds
- Ancillary and sanitary equipment
- Anti-decubitus equipment and accessories
- Stabilizing and immobilizing belts
- Electro-medical equipment
- Disposable medical equipment

Our complete line of products is available from our distributors.

Learn more at: timago.com.



Manufacturer:

LM GLOBAL Design Limited

Suite 74, Guinness Enterprise

Centre, Taylor's Lane,

D8 Dublin, Ireland



Issue I, date 23.11.2017