

Maintenance and refurbishment

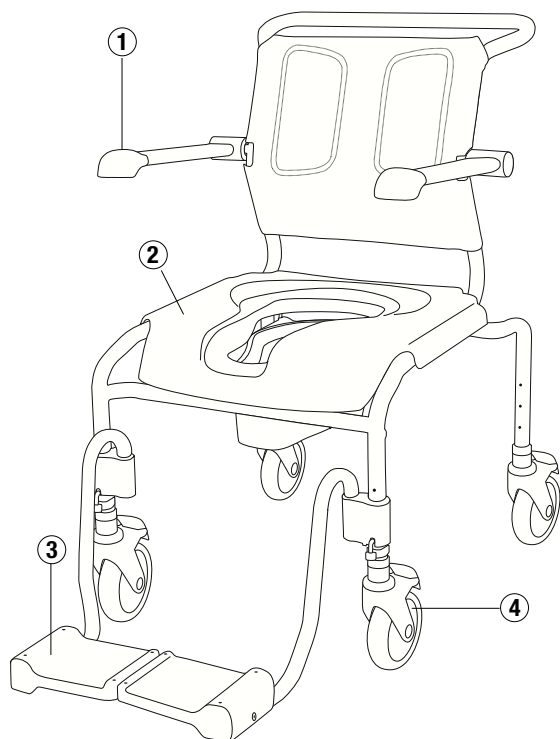

Maintenance

The commode is made of steel tubes (outer/inner coated) and aluminium. Exposed details that haven't been coated are made of aluminium/stainless steel. The commode can be cleaned with normal cleaning agents (could be cleaned in an autoclave 85 degrees). Check that the chair is not damaged and there are no loose parts.

Regular checks

1. Armrest- ensure that the glide protection/end caps are free from damage and fitted correctly.
2. Seat/softseat- is complete and without damage. There should be no sharp edges.
3. Footrest- is complete and can be adjusted. Make sure that the clips are complete and tightened.
4. Wheel- should spin easily. Check that the wheels are correctly tightened in the frame.

Basic

56-280 Shower Commode

Art 56-280 / 131023

Basic

56-280 Shower Commode

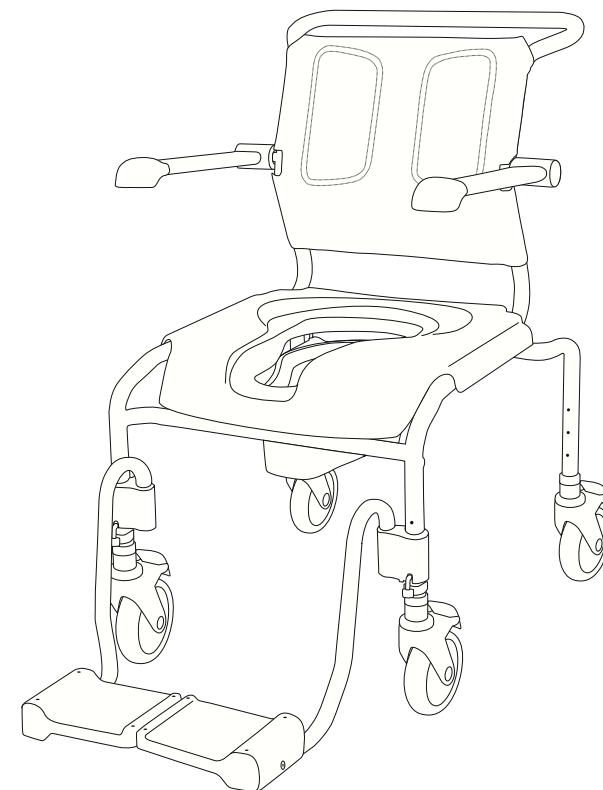

GATE Rehab Development AB
Industrigatan 2, S-330 21 Reftele
Phone: (+46) 0371-318 00
Fax: (+46) 0371-318 01
E-mail info@gaterd.se
www.gaterd.se

GATE
REHAB DEVELOPMENT AB

REHAB DEVELOPMENT AB

Manual instruction Basic

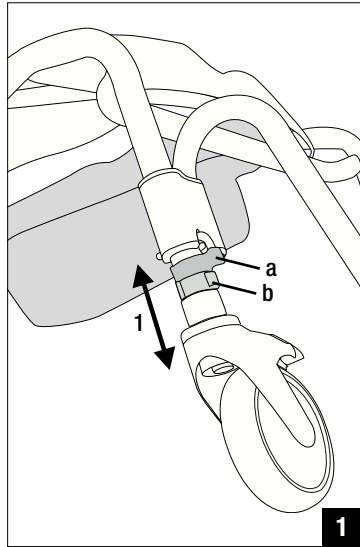

Height adjustment (1)

You can adjust the chair in two ways- either when the commode is standing on all wheels- or on it's side.

Adjusting the front wheels- loosen the footrest clips (a-green clips) and the telescope wheel (b-grey clips) Adjust the telescope wheel to required height (1), insert the GREY clips (the lowest hole)

Position the footrest to required height- tighten with GREEN clips.

Adjusting the rear wheels- loosen the telescope clips GREY clips.

Adjust the telescope wheel to required height- insert the GREY clips in the lowest hole in the frame.

When all the adjustment has been made- ensure that the CLIPS (a+b) have been mounted correctly= the clips are fitted correctly to the frame.

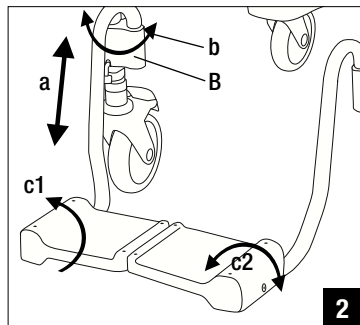

Footrest (2 & 3)

a) The footrest can be height-adjusted when removing the clip (see figure 3) and the footrest can be positioned to required height (don't forget to refit the clips)

b) The footrest can be angled at a side by gripping at B- lift upwards/swing

c) The footrest plate could be turned upwards (c1) and/or angled (c2) accordingly.

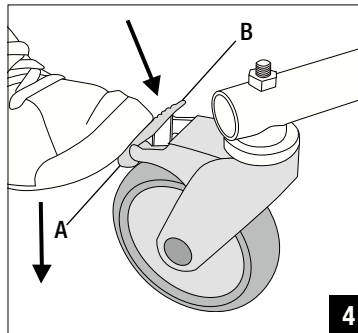
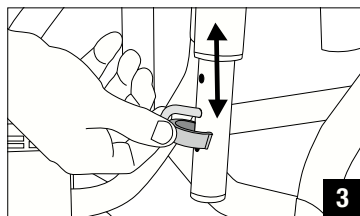

Locking wheel (4)

All the wheels are braked/locked.

Push lower part to brake (A).

Push upper part to release brake (B)

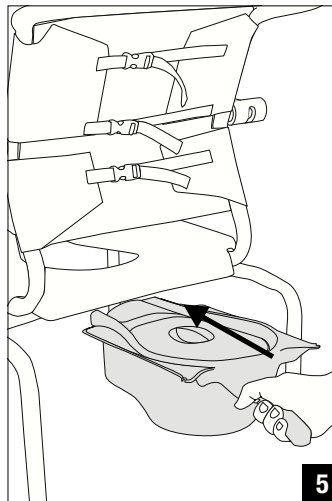

Sanitary pan (5 & 6)

The sanitary pan is pushed from the rear side between the seat and the panholder according to figure 5-6.

Make sure that the sanitary pan is pushed on top of the panholder. Also make sure that the sanitary pan will be in the correct position in relation to the seat.

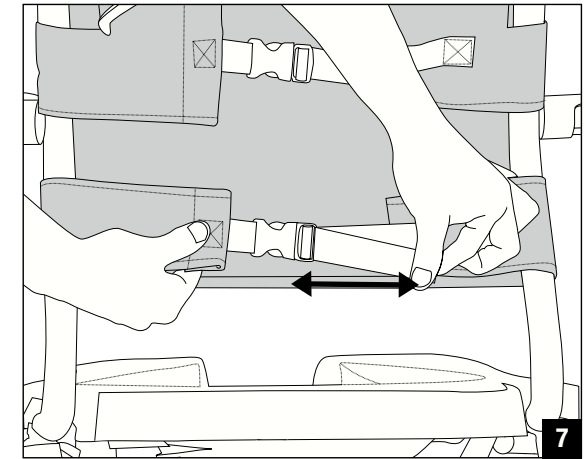
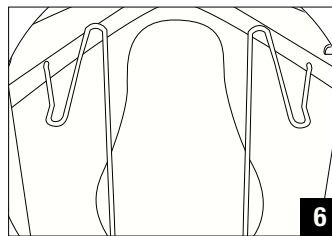

Mounting the backrest (7)

Attach the backrest around the backframe – lock with the snap.

Adjust to required position.

Make sure that the opening for the armrest is fitted towards the opening in the backrest.

Basic

56-280 Shower commode



Caution

Read the instruction carefully before using the commode.

- The prescriber is responsible that the product is suitable for the user.
- Max. user weight is 150 kg.
- Never stand on the Basic.
- Caution is to be taken when the ground is uneven and also when passing thresholds or similar obstacles.

Warranty

There is a 2 year warranty on possible manufacturing faults (does not include wear and tear).