

Preface

Congratulations on purchasing the Gemred I-DCB-150 Digital Callipers.

Parts and components

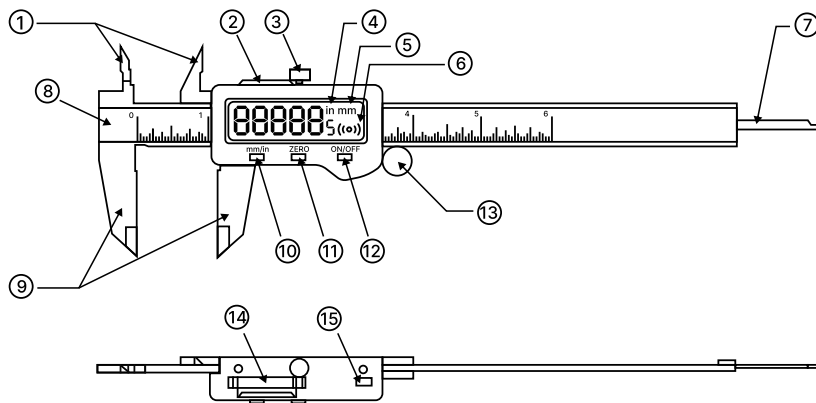

- | | |
|----|-------------------------------|
| 1 | Internal measuring claw |
| 2 | Battery cover |
| 3 | Locking screw |
| 4 | Inches unit indicator |
| 5 | Milimeters unit indicator |
| 6 | Wireless connection indicator |
| 7 | Depth measuring rod |
| 8 | Main frame |
| 9 | External measuring jaw |
| 10 | Unit button |
| 11 | Zero button |
| 12 | Power button |
| 13 | Adjust screw |
| 14 | Battery cover |
| 15 | Data button |

Usage

The callipers support three functions. Outer diameter measurement, using the large external measuring jaws (9); inner diameter measurement of holes, using the internal measuring claws (1) and hole depth measurement using the depth measuring rod at the end of the callipers (7).

Button function

- ON/OFF button: Short press to switch the device ON or OFF.
- Zero button: Short press to set the measurement to zero.
- Unit button: Short press to switch the measurement unit.
- Data button: Long press to enable connection between callipers and the IKONN Controller.

Battery replacement

If the display behaves incorrectly, for example flashing values, or no display, it indicates that the battery should be replaced. Follow the steps shown below to remove the battery compartment.

1. Use a tool such as tweezers or fingernail to pick up the clip on the upper side of the battery box.
2. Pick up the button cover.
3. Pull out the battery compartment. When loading the batteries, please note that the negative side of the batteries should be facing upwards.

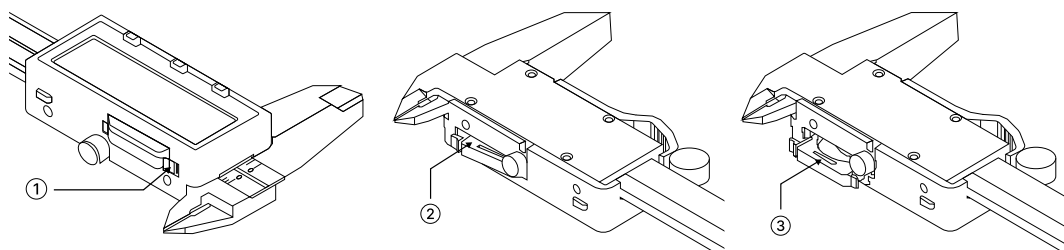

Using Callipers with IKONN Controller and myIKONN App

The callipers are compatible with the **IKONN Controller** or **myIKONN App** which can provide audio feedback for visually impaired users. The app also supports large-font display of values in real time for low-vision users who prefer this option.

To pair the callipers with your IKONN interface – **ensure that wireless transmission on the callipers is turned on when pairing**. Holding them in front of you with the raised battery box towards you and the larger jaws pointing downwards, the red data button is on the top surface of the battery box. Hold down the red data button on the callipers for approximately 5 seconds until the wireless transmission symbol shows on the screen. Use the help function on your controller/app or the manual for the controller if you are unsure how to do so.

Select the **Add product** function of the IKONN Controller or myIKONN App. It will announce when the connection is established and IKONN will also state the name of the product that it has connected with. The callipers function will subsequently be available for use. To use the callipers with IKONN, ensure they are switched on and select the callipers function in the Controller or app.

You can find more support using the built-in IKONN controller help functions or on the <https://ikonn.info> website.

Technical specifications

Range and resolution	150mm +/- 0.01mm	Bluetooth transmission distance	Barrier-free transmission distance is not less than 3m
Transmission frequency range	2402MHz - 2480MHz	RF TX Power	0.9dBm
Indication error	150mm:±0.02mm	Source of electricity	1*CR2032 battery, voltage 3.0V
Response speed	1m/s	Operating temperature	0C ~ 40C
Working conditions	Temperature 0~+40°C; Relative humidity < 80%	Transport or storage temperature	-10C ~ 60C
Weight	175 g	Humidity at work	≤ 80%
Electromagnetic compatibility	Class II	Dimensions	235 x 77.6 x 15.3 mm

Handling and safety

Warning: Read all safety information below before using the callipers and keep this manual for future reference. Failure to follow these safety instructions could result in fire, electric shock, or other injuries, as well as damage to the product or other property.

The callipers are not intended for commercial or industrial use. The measurement jaws are sharp and should be handled with care. They are not suitable for use by small children.

General Safety and Handling

Handle the product carefully, as it contains sensitive electronics. Check for visible damage before use and contact your retailer if any is found. Do not attempt to open, repair, or modify the product, as this may cause injury or void the warranty. Avoid dropping it or exposing it to mechanical shock.

Use only within acceptable temperature ranges and avoid extreme heat, humidity, dust, vibration, or insect exposure. Keep the product clean and dry; avoid contact with liquids. Clean only with anhydrous alcohol—do not use acetone or similar solvents.

Avoid magnetic fields and keep away from magnetic objects. If magnetized, demagnetize before use. Replace the battery if the display flashes or becomes unreadable. This device has an auto-shutdown feature after 5 minutes of inactivity. For long-term storage, remove the battery and store in its case.

Battery Safety

Recycle batteries properly; do not dispose of them in household waste.. Never mix old and new batteries or different types. Do not deform, heat, burn, short-circuit, or tamper with batteries.

Remove batteries during long storage to prevent leakage. Keep batteries out of reach of children. Swallowing button cell batteries can cause severe internal injury or death—seek immediate medical help if ingestion is suspected.

Tips and troubleshooting

Phenomenon	Possible reason	Solution
Display blur/flicker	Battery low voltage	Replace the battery
Does not display/cannot boot	Battery low voltage	Replace the battery
Display digital lock unchanged	Internal fault	Remove the battery, wait 1 minute and reinstall it

You can find a list of solutions for the most frequently occurring issues at: ikonn.info/support/callipers

If you experience problems in operating your product, please contact the retailer where you purchased it. If you are unable to make contact with them, contact the manufacturer at: ikonn.info/support

Support and warranty

This product is warranted against defects in materials and workmanship for a period of two years from the date of original purchase. This warranty does not cover damage caused by misuse, accident or unauthorized modifications. For parts subject to wear and tear, including the battery, the warranty is six months. Please retain your proof of purchase.

Disposal of electronic appliances



The product and/or batteries should be disposed of separately from household waste. Upon reaching the end of its operational life, ensure the proper disposal of cells, batteries, or accumulators by delivering them to a collection point designated by your local authorities. Consumers are encouraged to reach out to their local authorities or the retailer for guidance on the correct disposal of old machines and their associated batteries. In the EU these rules are governed by directive 2012/19/EU (Waste Electrical and Electronic Equipment).