

Drinksaver

Instructions for use:

If the lid is difficult to attach and detach

The lid may be difficult to click on and off the glass in the beginning. Before use, make sure to wash the product by hand or in a dishwasher. After being washed and used, the lid becomes easier to attach and detach.

Attaching and detaching the lid becomes easier after used a couple of times.

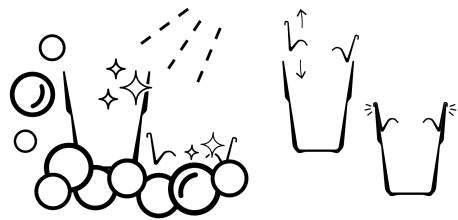

How to wash

We recommend that you wash your products by hand. Handwashing does not strain the products in the same way as using a dishwasher. Each product can withstand being washed up to 2000 times.

We recommend 40-65 degrees Celcius when using a dishwasher. The temperature should be kept as low as possible when washing the products.

We recommend a maximum of 90 degrees Celcius for industrial dishwashers for a short period.

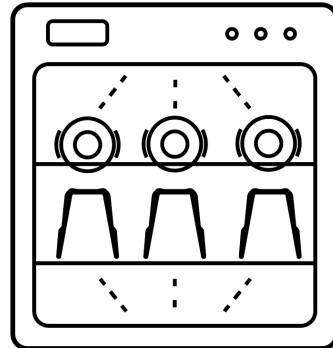

Secure the lid properly

Securely place the lid onto the glass. The lid can be placed before or after the beverage is poured. Ensure that the lid is tightly sealed to prevent any spills or leaks.

The lid may be difficult to click into the glass in the beginning. After being washed and used a couple of times, the lid becomes easier to attach and detach.

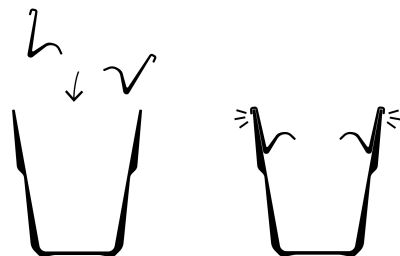

How do properly remove the lid

The lid is attached by two snap-fits. Therefore, it is difficult to remove the lid, if pulling on both ends because this only will tighten the snap-fit and make it more difficult to remove.

To properly remove the lid, tilt one snap-fit up at the time. The lid can be removed with ease by lifting up in one end and then pulling the lid off.

Another simple way to remove the lid, is by pulling straight up from inside the middle opening in the lid.

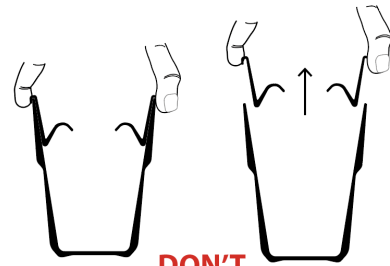

DON'T

Pull straight up in both ends

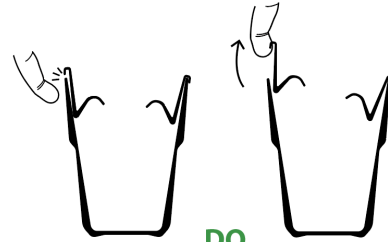

DO

Tilt one end up first

Place the lid before or after pouring

If the lid is attached before pouring: Aim for the opening in the centre of the lid to ensure that your beverage does not splash when poured.

If the lid is attached after pouring: It is important not to overfill the glass as the added volume from the lid can cause the beverage to overflow. Leave some room at the top of the glass to avoid overflow.

If you need to refill your beverage, pour it into the opening in the middle of the lid.

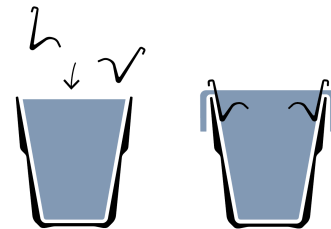

Filling the glass to above the lid

If filled above the lid, it will still prevent spillage to some extent, but the lid is most effective if the beverage is below the lid.

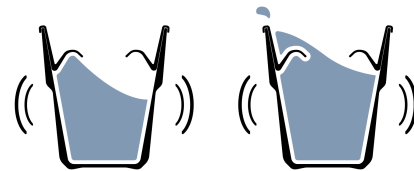

The lid doesn't prevent pouring during tilt

With or without the lid placed in the glass, the beverage will pour as usual. The lid will not prevent spillage when the glass is tilted over. The user can drink from the glass as if the lid was not in place.



Hot beverages

Polycarbonate is suitable for handling hot beverages due to its high heat resistance. The surface of the glass will have a pleasant temperature to hold.

But be cautious when handling hot beverages, and be careful if removing the lid while the glass is full, as it may cause the hot beverage to splash.



Microwave

The products can be microwaved for a short period without the grill function. We recommend a maximum of 1-2 minutes at a time. (Using a microwave results in a shorter life span.)

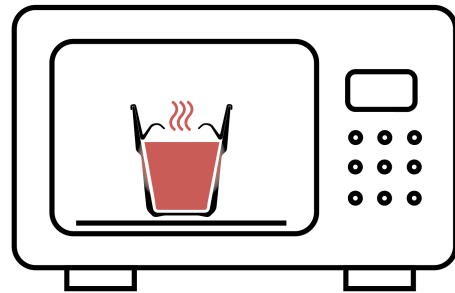

Where to drink from

When drinking from the glass, drink from the rim as you would normally do and not the rim of the lid.

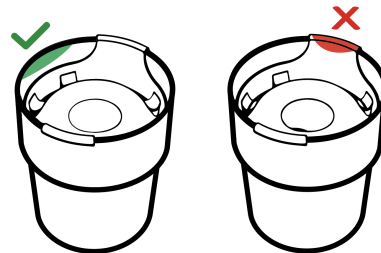

Stack the products

The glasses and the lids can be easily stacked to minimise space while stored.

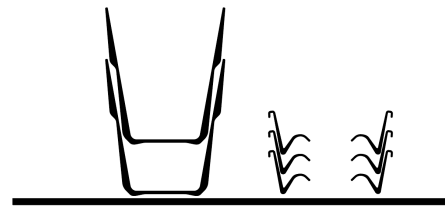

Safety Warnings and Precautions:

- The products can come in contact with all types of food.
- The material used for the products has been manufactured in accordance with the relevant requirements of Commission Regulation EC No. 2023/2006 on good manufacturing practice for materials and articles intended to come into contact with food.
- The products have been subjected to global migration tests and comply with the Global Migration Limits set out in Regulation (EU) No 10/2011.
- The products are safe for repeated use (reusable).
- The products can withstand freezing temperatures (-24 to -18 °C)
- The products can withstand refrigeration (3 to 5 °C)
- The products are safe to use in hot and/or heating containers to a temperature of 70°C for a maximum of 120 minutes and/or 100°C for a maximum of 10 minutes.
- Do not expose the products to temperatures above 100°C.
- The products are shatter-proof, but do not use them if they are cracked or damaged.
- Do not handle the lid as a 100% enclosed spill-proof lid. Drinksaver's lid is an open design and only minimises spillage.
- The beverage will not remain in the glass if the drinking glass is tilted over or dropped while the lid is attached.
- Alcoholic beverages derived from aniseed can ruin all plastic materials without exception.
- The drinking glass and the lid can be washed with warm, soapy water or washed in a dishwasher (both consumable and industrial). Cleaning the glass and lid by hand is recommended to extend the lifetime.
- Do not use abrasive materials or harsh chemicals to clean the glass. This will result in scratches on the outer surface.

Contact Information:

If you have any questions or concerns about the drinking glass, please contact Drinksaver ApS at contact@drinksaver.dk.